

LED FLUSH MOUNT KIT USER MANUAL

12-24VDC

WIRING

- To Chassis Ground:..... **BLACK**
- To+VDC for Warning Mode**①** (fuse @ 1A):..... **RED**
- Default Color Mode - Color 1
- To+VDC for Warning Mode**②** (fuse @ 1A):..... **WHITE**
- Default Color Mode - Color 2
- To+VDC for Warning Mode**③** (fuse @ 1A):..... **RED+WHITE**
- Default Color Mode - Color 1 alt. 2
- (Order Precedence : Mode**③** > Mode**②** or Mode**①**)
- For Synchronization and Flash Pattern:..... **YELLOW**

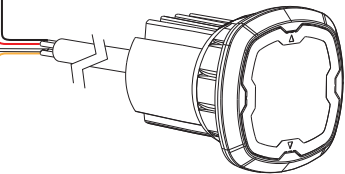

Connect **YELLOW** wires of all lightheades together for synchronization.
(All lightheades should be set to the same pattern)

OPERATION

For Flash Pattern Selection

While in Warning Mode, momentarily apply +VDC to **YELLOW** wire:

- once to next pattern
- quickly three times to FP#1 (Refer ro Flash Pattern Chart)

For Simultaneous or Alternating Flash

1. Apply +VDC to **RED** and **YELLOW** wires simultaneously to enter *SETTING MODE*; lighthead will display short (single or double) flashes:
 - Single flash = Group 1
 - Double flash = Group 2
 2. Remove **YELLOW** wire from +VDC then momentarily apply +VDC again for more than 3 seconds to change Groups.
 - Lightheades of the same Group will flash together.
 - Lightheades of different Groups will flash alternately.
 3. Save and Exit the *SETTING MODE* by powering off the lighthead.
- NOTE:** All warning memories share the same Group setting.

For Color Mode Setting

1. Apply +VDC to **RED** and **YELLOW** wires simultaneously to enter *SETTING MODE*; lighthead will display short (single or double) flashes:
 - Single Color flashing Color 1 = Color1
 - Single Color flashing Color 2 = Color2
 - Dual Color flashing Color 1 = Color1 alt 2
 - Dual Color flashing Color 2 = Color2 alt 1
2. Remove **YELLOW** wire from +VDC then momentarily apply +VDC again for less than 3 seconds to change Color Mode.
3. Save and Exit the *SETTING MODE* by powering off the lighthead.

Reset to Factory Default Settings

1. Apply +VDC to **RED** and **YELLOW** wires simultaneously to enter *SETTING MODE*
2. Remove **YELLOW** wire from +VDC then momentarily apply to +VDC again more than 5 seconds.
The lighthead will display fast shrot flashers to signify restoring successfully.
3. Save and Exit the *SETTING MODE* by powering off the lighthead.

Flash Pattern					
1	Double	[R65*]	8	Double	[SAE]
2	Single	[2Hz]	9	Triple	[SAE]
3	Triple	[2Hz]	10	Quad	[SAE]
4	Quad	[2Hz]	11	Quint	[SAE]
5	Random		12	Mega	
6	Steady EF**		13	Giga	
7	Single	[SAE][CA13]	14	Ultra	[SAE]
15	Single-Quad		16	Single H/L	
17	Single-Triple-Quint		18	Steady Scene	
19	Single-Single		20	Double-Double	
21	Triple-Triple Mid		22	Triple-Triple Fast	
23	Quint-Triple		24	7-1 Flash	
25	7-1 Flash #		26	Quad-Single	
27	Quad-Single#		28	Quint-Quint	

FP#19-28 will always operate in dual color.
Inverted color mode.
*Actual approval will be based on the model ordered.
** For use with external flash controller

INSTALLATION

Pop-n-Lock

Recommended Surface thickness @1.5~4.0mm

- 1 Select a mounting location and drill an 1.14" (29mm) cut-out, and then install the LIGHTHEAD onto the cut-out.

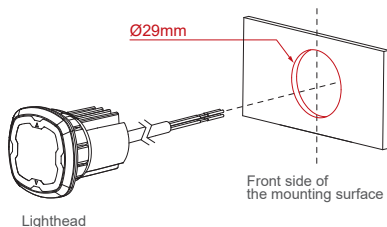

NOTE: To install more efficiently, use a rotating motion to guide the LIGHTHEAD when installing onto the cut-out.

- 2 Ensure that the optical stripes are aligned vertically.

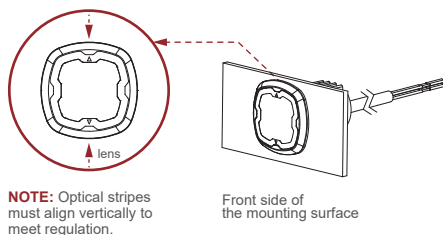

- 3 Where necessary, apply silicone around the reverse side to prevent from rotating.

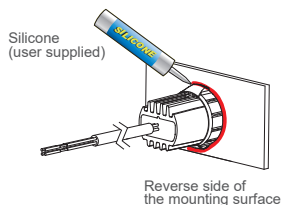

Bracket Mount* (sold-separately)

- 1 From the front, install the LIGHTHEAD onto the BRACKET.

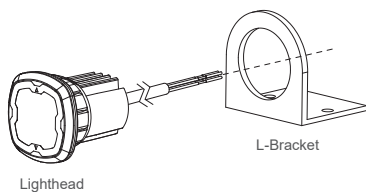

NOTE: To install more efficiently, use a rotating motion to guide the LIGHTHEAD when installing onto the BRACKET.

- 2 Ensure that the optical stripes are aligned vertically.

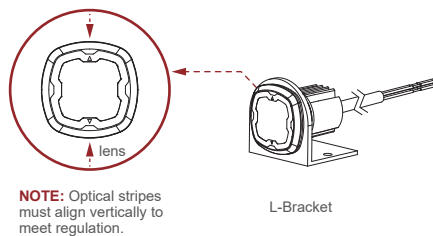

- 3 Secure the BRACKET onto the desired mounting surface with screws.

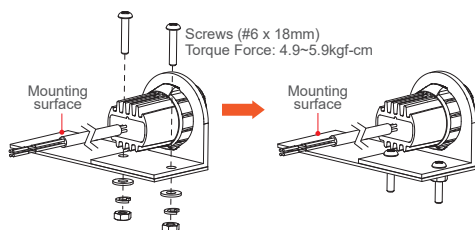

- 4 Where necessary, apply silicone around the reverse side to prevent from rotating.

